

Aluminium Inlet Filters

Aluminium & stainless steel construction
 Open & enclosed designs
 Low cost
 Ideal for environment monitoring

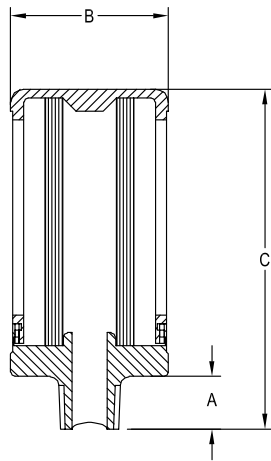

Headline aluminium inlet filters are offered in two versions, open and enclosed. Enclosed versions should be specified if the filter is to be located where it could be damaged accidentally. These filters are extensively used in environment monitoring applications.

Principal Specifications

| Housing Model | 910 | 915 | 920 | 910E | 915E | 920E |
|--------------------------------------|-------------|-------------|-------------|-------------|-------------|-------------|
| Port Size - mm or NPT | ø6.3 | ø6.3 | ø6.3 | 1/8" | 1/4" | 1/2" |
| Maximum Temperature - °C | 150 | 150 | 150 | 150 | 150 | 150 |
| Materials of Construction (1) | | | | | | |
| Head | AL | AL | AL | AL | AL | AL |
| Cover | - | - | - | AL | AL | AL |
| Tie Rod | 316L | 316L | 316L | - | - | - |
| Element Retainer | AL | AL | AL | - | - | - |
| Principal Dimensions | | | | | | |
| A - mm | 12 | 12 | 20 | 12 | 12 | 22 |
| B - mm | 19 | 19 | 36 | 36 | 36 | 50 |
| C - mm | 50 | 75 | 91 | 53 | 78 | 92.5 |
| Weight - kg | 0.01 | 0.01 | 0.05 | 0.05 | 0.05 | 0.15 |
| Filter Element Codes (2) | | | | | | |
| Disposable Element | 12-32-xx | 12-57-xx | 25-64-xx | 12-32-xx | 12-57-xx | 25-64-xx |
| Stainless Steel Element | SS-12-32-xx | SS-12-57-xx | SS-25-64-xx | SS-12-32-xx | SS-12-57-xx | SS-25-64-xx |
| PFTE Element | PT-12-32-xx | PT-12-57-xx | PT-25-64-xx | PT-12-32-xx | PT-12-57-xx | PT-25-64-xx |

Notes (1) Material abbreviations, 316L = 316L Stainless steel, AL = Aluminium
 (2) Replace 'xx' with grade required, e.g. 12-32-60K, SS-12-57-10, PT-25-64-03